

QUIET FAN SPEED CONTROL

Single Pole or 3-Way
Cat. No. DSF01 – Ceiling Fan 1.5A
120VAC, 60Hz

WARNINGS AND CAUTIONS:

- **TO AVOID FIRE, SHOCK, OR DEATH: TURN OFF POWER** at circuit breaker or fuse and test that power is off before wiring or servicing fixture!
- **TO AVOID FIRE, SHOCK, OR DEATH:** this control is to be used with ceiling fans that are rated 120VAC, total load 1.5 amperes maximum.
- To be installed and/or used in accordance with appropriate electrical codes and regulations.
- If you are unsure about any part of these instructions, consult an electrician.
- Use this device with **copper or copper clad wire only**.

WARNINGS AND CAUTIONS:

- For use on ceiling paddle fans with split-capacitor or shaded pole motors only. Please refer to manufacturer's instructions or rating label on the motor to confirm type. Use with any other types of motors or equipment may cause overheating and/or damage to the motors or equipment.
- Use only one (1) Fan Speed Control per load. The switch(es) will turn ON the fan at the speed level selected at the control.
- To avoid overheating and possible damage to this device and other equipment, **DO NOT** install to control a receptacle, fluorescent lighting, a motor or a transformer-operated appliance other than appropriate ceiling fans.

Tools needed to install your Fan Speed Control

- | | | |
|-----------------------------|-----------------|---------|
| Slotted/Philips Screwdriver | Electrical Tape | Ruler |
| Pliers | Pencil | Cutters |

Changing the color of your Fan Speed Control

If a color change kit is provided with your device, proceed with the following step before wiring the device if you need to change the color. Otherwise, proceed with the "Installing your Fan Speed Control" section.

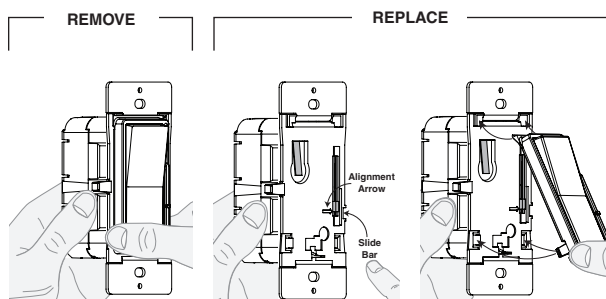

Press the side of the color kit at either bottom tab and pull forward to release.

Align slide bar with alignment arrow as shown. Move the slide bar of the color kit to the bottom.

Insert top tabs of the color kit into the slots on the top of the fan control. Then press the bottom of the color kit in until it snaps into place.

Installing Control by itself or with other devices

NOTE: There is NO derating necessary for multi-gang installations of this Fan Speed Control.

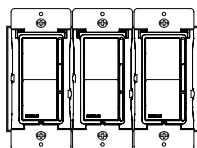

Installing your Fan Speed Control

NOTE: Use check boxes when Steps are completed.

Step 1 **WARNING: TO AVOID FIRE, SHOCK, OR DEATH; TURN OFF POWER** at circuit breaker or fuse and test that power is off before wiring or servicing fixture!

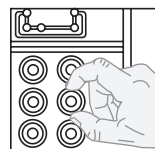
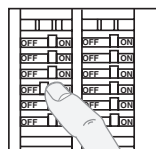

Step 2 **Identifying your wiring application (most common):**

NOTE: If the wiring in the wall box does not resemble any of these configurations, consult an electrician.

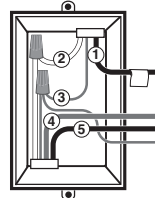
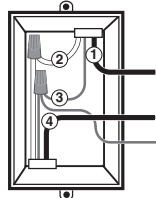

Single Pole

1. Line (Hot)
2. Neutral
3. Ground
4. Load

3-Way

1. Line or Load (See note below)
2. Neutral
3. Ground
4. First Traveler – note color
5. Second Traveler – note color

NOTE: For 3-Way applications, note that one of the screw terminals from the old switch being removed will usually be a different color (Black) or labeled Common. Tag that wire with electrical tape and identify as the common (Line or Load) in both the Fan Speed Control wall box and 3-way switch wall box.

Step 3 Preparing and connecting wires:

- Make sure that the ends of the wires from the wall box are straight (**cut if necessary**).
- Remove 5/8" (1.6 cm) of insulation from each wire in the wall box (shown).
- **For Single-Pole Application, go to Step 4a.**
- **For 3-Way Application, go to Step 4b.**

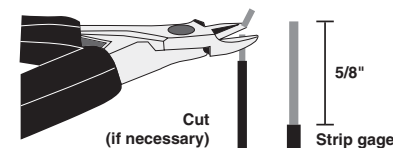

Step 4a Single-Pole Wiring Application:

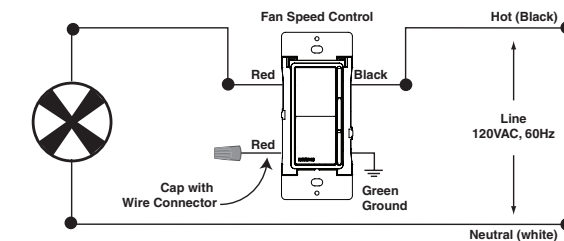
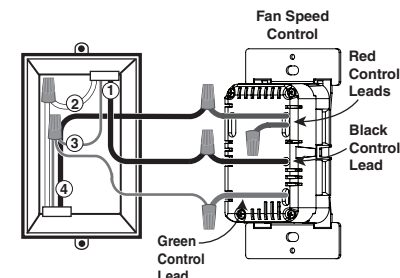

Step 4a cont'd

Connect wires per **WIRING DIAGRAM** as follows:

- Green or bare copper wire in wall box to **GREEN** control lead.
 - Line Hot wall box wire to **BLACK** control lead.
 - Load wall box wire to **RED** control lead.
 - Remaining **RED** control lead should have a label affixed. **DO NOT REMOVE** this label in a single pole application.
- NOTE:** If the insulating label is not affixed to the second **RED** lead use electrical tape or a wire connector to cover.

Proceed to Step 5.

Step 4b 3-Way Wiring Application:

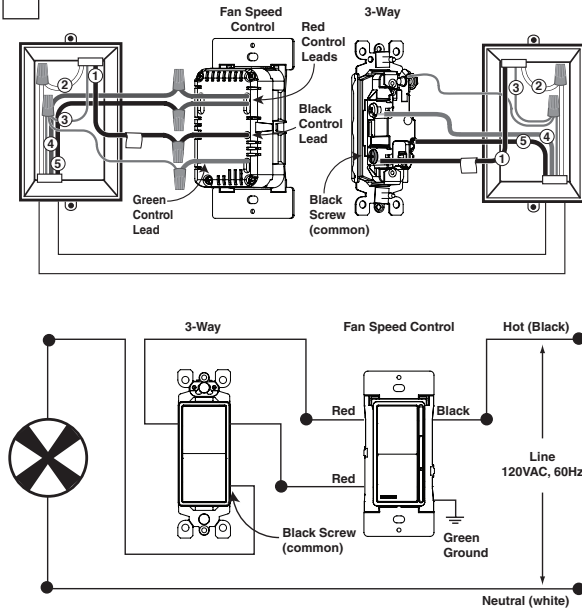

Connect wires per **WIRING DIAGRAM** as follows:

- Green or bare copper wire in wall box to **GREEN** control lead.
- Common (Line hot or Load) wire to **BLACK** control lead.
- Remove insulating label and connect the first traveler wire to the **RED** control lead.
- Connect the second traveler wire to the remaining **RED** control lead.

Proceed to Step 5.

Step 5 Testing your Fan Speed Control prior to mounting in the wall box:

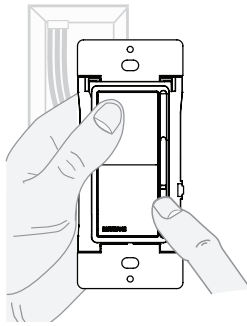

- Restore power at circuit breaker or fuse.
- Carefully holding the Fan Speed Control, move slider control lever to highest position and press the top of the Decora® rocker. Fan should turn ON to highest Speed.

If fan does not turn ON, refer to the **TROUBLESHOOTING** section.

Step 6 Fan Speed Control Mounting:

TURN OFF POWER AT CIRCUIT BREAKER OR FUSE.

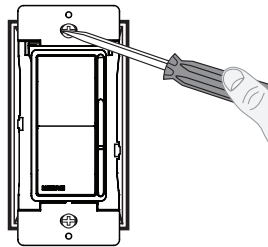

Installation may now be completed by carefully positioning all wires to provide room in wall box for the control. Mount the control into box with mounting screws supplied. Attach wallplate.

Step 7 Restore Power:

Restore power at circuit breaker or fuse.

Installation is complete.

Operation

NOTE: If using the control in a 3-way application, the control will turn ON at the speed level set on the control's slide bar. The fan can be controlled from either the control or the switch location.

ON/OFF:

- Press top of Decora® rocker
 - Fan will turn ON.
- Press bottom of Decora® rocker
 - Fan will turn OFF.

CHANGING SPEEDS:

- Move slide bar
 - Fan will change speeds.

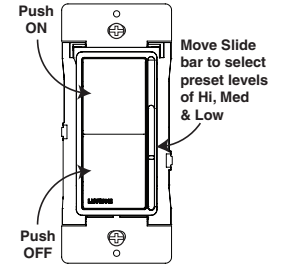

Troubleshooting

- Fan does not turn ON
 - Circuit breaker or fuse has tripped.
 - Fan has burned out.
 - Fan Neutral connection is not wired.

For Technical Assistance Call: 1-800-824-3005 (U.S.A. Only) www.leviton.com

FOR CANADA ONLY

For warranty information and/or product returns, residents of Canada should contact Leviton in writing at **Leviton Manufacturing of Canada Ltd to the attention of the Quality Assurance Department, 165 Hymus Blvd, Pointe-Claire (Quebec), Canada H9R 1E9** or by telephone at 1 800 405-5320.

© 2014 Leviton Mfg. Co., Inc

DI-000-DSF01-02A

LIMITED 5 YEAR WARRANTY AND EXCLUSIONS

Leviton warrants to the original consumer purchaser and not for the benefit of anyone else that this product at the time of its sale by Leviton is free of defects in materials and workmanship under normal and proper use for five years from the purchase date. Leviton's only obligation is to correct such defects by repair or replacement, at its option. For details visit www.leviton.com or call 1-800-824-3005. This warranty excludes and there is disclaimed liability for labor for removal of this product or reinstallation. This warranty is void if this product is installed improperly or in an improper environment, overloaded, misused, opened, abused, or altered in any manner, or is not used under normal operating conditions or not in accordance with any labels or instructions. There are no other or implied warranties of any kind, including merchantability and fitness for a particular purpose, but if any implied warranty is required by the applicable jurisdiction, the duration of any such implied warranty, including merchantability and fitness for a particular purpose, is limited to five years. Leviton is not liable for incidental, indirect, special, or consequential damages, including without limitation, damage to, or loss of use of, any equipment, lost sales or profits or delay or failure to perform this warranty obligation. The remedies provided herein are the exclusive remedies under this warranty, whether based on contract, tort or otherwise.