

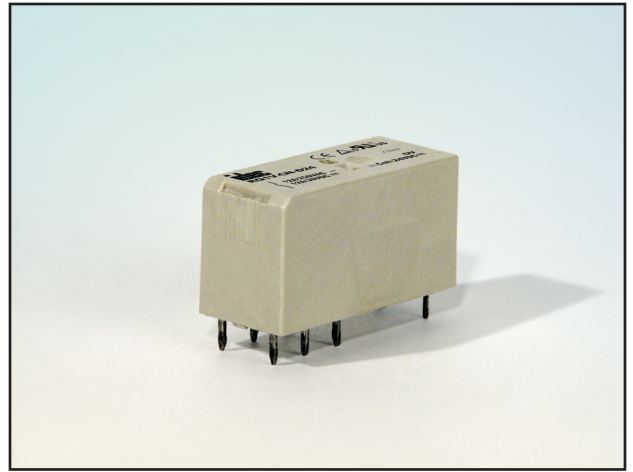

RQ Series Relays

- Features**
- Low profile:
29 x 12.7 x 15 mm
 - Contact rating:
8A and 12A
 - Power relay model with 16A contact rating
 - Operational life:
100K cycles at full resistive load
10 million cycles, no load
 - LED/Diode Plug-in modules available with DIN rail socket



IDEC's RQ relays are low-profile, PCB relays that provide quality within a compact package. Size equals value. RQ relays are small, yet maintain high contact ratings and long operational life. For larger power needs, a 16A model is also available.



Specifications

		RQ1	RQ2	RQ1 HC
General information	No. of poles	1	2	1
	Contact Configuration	SPDT	DPDT	SPDT
	Contact Rating	12A	8A	16A
	Contact Material	Silver-Nickel alloy		
	Contact Resistance	100 milliohms max		
	Operating Time	12 ms max		
	Release Time	8 ms max		
	Dielectric Strength	Between contact and coil Between contacts	5,000VAC, 1 minute 1,000VAC, 1 minute	
	Vibration Resistance	Damage limits Operating extremes	10-55 Hz, amplitude 1.5mm 10-55 Hz, amplitude 1.5mm	
	Shock Resistance	Damage limits Operating extremes	100m/s ² min (10G) 1,000m/s ² min (100G)	
	Mechanical Life	10,000,000 operations		
	Electrical Life @ Full Rated Load	100,000 operations		
	Operating Temperature	-40 to 85° C		
	Operating Humidity	45 to 85% RH		
	Dimensions (H x W x D mm)	29 x 12.7 x 15		
Weight (Approx.)	15g			

Coil Ratings	Coil Sensitivity	Nominal Voltage	Nominal Current		Coil Resistance	Power Consumption		Pull-in Voltage	Drop-Out Voltage	Max Allowable Voltage
			50HZ	60HZ		50HZ	60HZ			
	DC Coil	12V	33.3mA		360Ω	0.40W		80% Max	5% Min	130%
24V		16.7mA		1,440Ω						
110V		4.1mA		26,530Ω						
AC Coil	24V	29.75mA	25.35mA	350Ω	0.71W	0.61W	30% Min			
	115V	7.65mA	6.3mA	8,100Ω	0.88W	0.73W				
	230V	3.42mA	2.72mA	32,500Ω	0.79W	0.63W				

Specifications con't on following page

Ordering Information

R Q V - C -

Contact Configuration	Pin Spacing	Coil Voltage
1 - SPDT 2 - DPDT	M - 3.5mm, SPDT 12A H - 5mm, SPDT 16A* N - 5mm, DPDT 8A *mounts in DPDT socket	D12 - DC12V; D24 - DC24V A24 - AC24V; A115 - AC120V; A230 - AC240V

RQ1 Dimensions

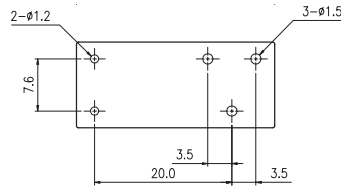
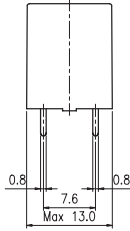
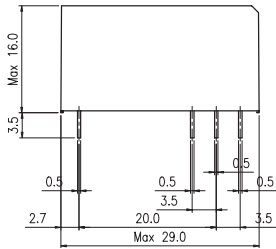

Bottom views

RQ1

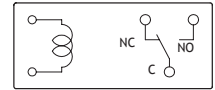

RQ2/RQ1 HC Dimensions

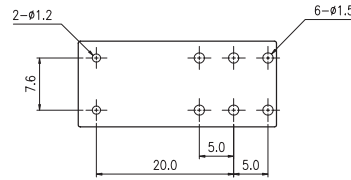
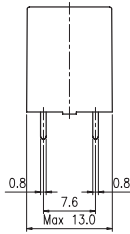
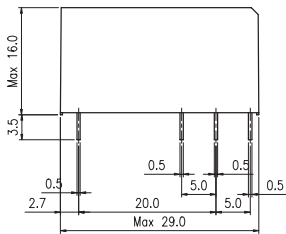

Bottom views

RQ2

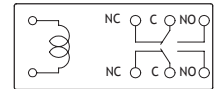

RQ1 HC

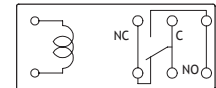

SQ1V Dimensions

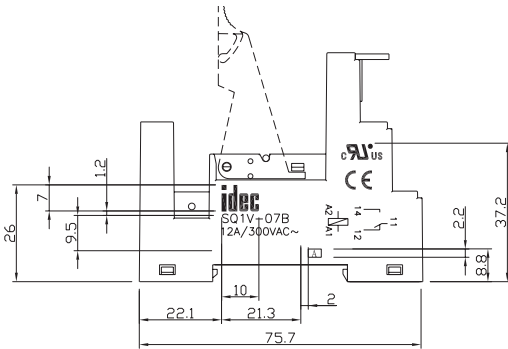

SQ2V Dimensions

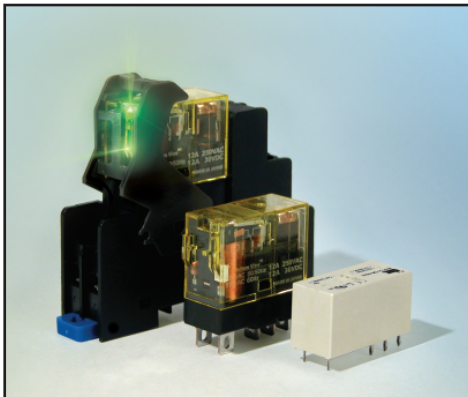
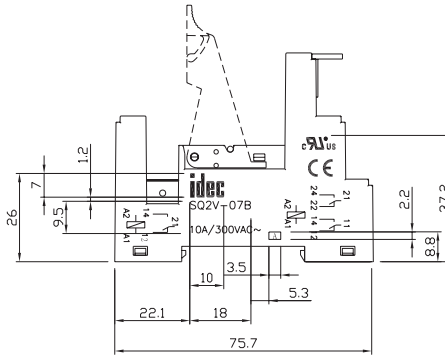

For more information on these and other IDEC relays, visit:

www.idec.com/relay

For additional information, call IDEC at: 800-262-IDECA (4332)
1175 Elko Drive • Sunnyvale, CA 94089
Fax: 408-745-5258 • www.idec.com

©2005 IDEC Corporation. All Rights Reserved.
Catalog No. RQ9Y-DS100-0 06/05 10K

Accessory part numbers	Description
SQ1V-07B	SPDT Finger-safe Socket
SQ2V-07B	DPDT Finger-safe Socket
SQ9Z-C	Replacement Retaining Clip
SQ9Z-LD	Socket Plug-in LED & Diode Module (6-24V DC)
SQ9Z-LR	Socket Plug-in LED & RC Module (110-230V AC)
SQ9Z-P	Replacement Marking Plate