

**INSTALLATION AND APPLICATION INSTRUCTIONS**  
**INSTRUCCIONES DE INSTALACIÓN Y EMPLEO - INSTRUCTIONS D' INSTALLATION ET D' UTILISATION**

<b>1</b>	Isometric view - Vista isométrica - Vue isométrique
<b>2</b>	Dimensions (all dims in mm unless otherwise noted) Dimensiones (todas las dimensiones son en mm, salvo que sea indicado de otra manera) Dimensions (toutes les dimensions sont en mm, sauf indication contraire)
<b>3</b>	Cable entry - Entrada cables - Entrée câbles
<b>4</b>	Mounting - Fijación - Montage
<b>5</b>	TO AVOID UNINTENTIONAL OPENING, LOCK THE PRODUCT USING THE SCREW AND THE WASHER PROVIDED PARA EVITAR LA APERTURA INDEBIDA, BLOQUEAR EL PRODUCTO CON EL TORNILLO Y LA ARANDELA PROPORCIONADOS POUR EVITER L'OUVERTURE IMPROPRE, BLOQUER LE PRODUIT AVEC LA VIS ET LA RONDELLE FOURNIES

<b>ATTENTION</b>	Disconnect power before servicing
<b>ATENCIÓN</b>	Desconecte la corriente antes de abrir el producto
<b>ATTENTION</b>	Débranchez l'alimentation avant de toute intervention sur le produit

**SLMBS - 012 - 024**

**1**

**2**

**3**

**4**

**5**

**SLMBD - 012 - 024**

**SLMBD - 120 - 240**

**1**

**1**

**2**

**3**

**4**

**5**

**SLMBW - 012 - 024**  
**SLMBW - 120 - 240**

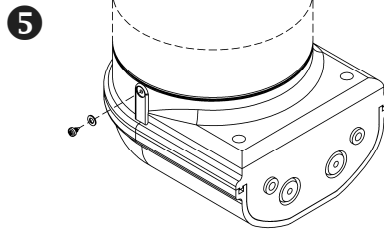
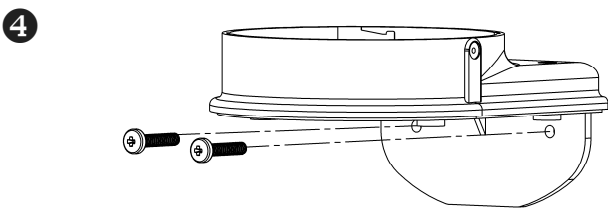
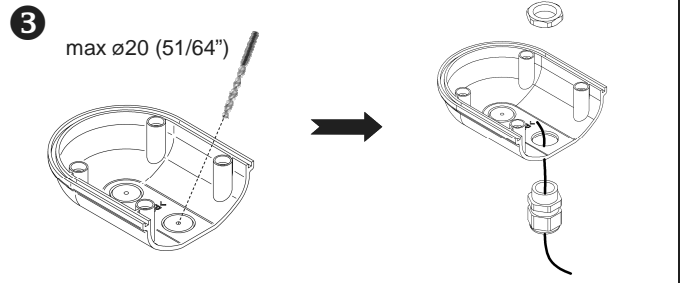
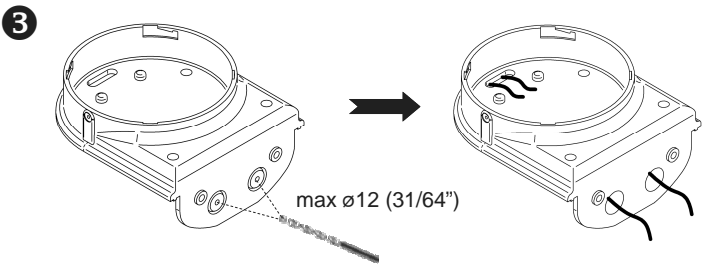
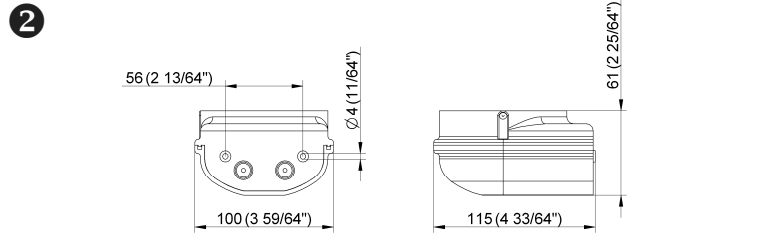
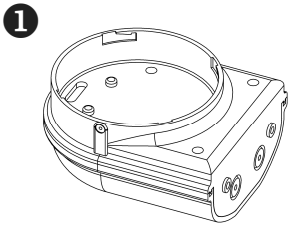

**SLMBT - 012 - 024**  
**SLMBT - 120 - 240**

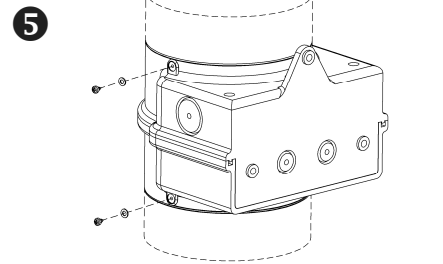
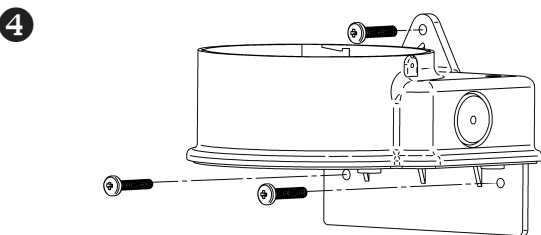
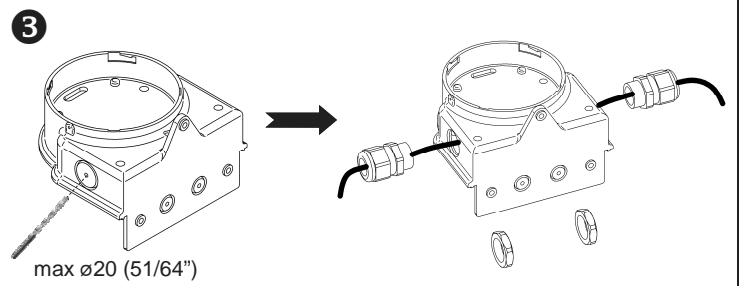
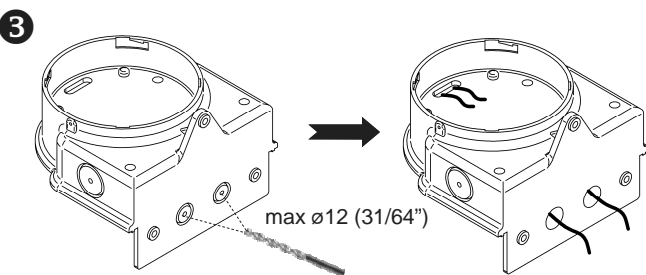
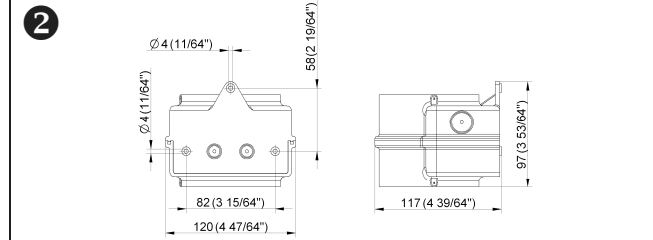
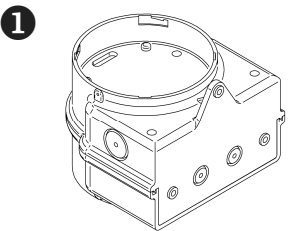

**TO BE INSTALLED BY QUALIFIED PERSONNEL ONLY**

**LA INSTALACIÓN SÓLO DEBE SER REALIZADA POR PERSONAL CUALIFICADO - L'INSTALLATION DOIT ÊTRE EFFECTUÉE PAR PERSONNEL QUALIFIÉ**



**NOT TO BE DISPOSED OF AS COMMON WASTE - NO ELIMINAR COMO DESECHO URBANO - NE PAS ELIMINER COMME DECHET URBAIN**