



HOLDER FOR STAND-ALONE INSTALL. FOR
3RU11/3RB10 SIZE S0 STAND-ALONE
INSTALLATION MAIN CIRC.: SCREW TERMINAL
AUX.CIRC.: --

General technical data:

product brandname		SIRIUS
Product designation		individual mount
Size of overload relay		S0
Ambient temperature		
<ul style="list-style-type: none"> during storage 	°C	-50 ... +80
<ul style="list-style-type: none"> during operation 	°C	-20 ... +70







Installation/ mounting/ dimensions:

Mounting type		screw and snap-on mounting onto 35 mm standard mounting rail
Width	mm	45

Connections/ Terminals:

<ul style="list-style-type: none"> <ul style="list-style-type: none"> Type of connectable conductor cross-sections for main contacts finely stranded <ul style="list-style-type: none"> with core end processing Type of connectable conductor cross-sections at AWG conductors 		1 ... 6 mm ²
--	--	-------------------------

Certificates/ approvals:

General Product Approval		Declaration of Conformity	Test Certificates	Shipping Approval	
 UL		 EG-Konf.	Special Test Certificate	 ABS	 BUREAU VERITAS
Shipping Approval		other			
 RINA	 RMRS	Environmental Confirmations	Confirmation		

Further information

Information- and Downloadcenter (Catalogs, Brochures,...)<http://www.siemens.com/industrial-controls/catalogs>**Industry Mall (Online ordering system)**<http://www.siemens.com/industrymall>**Cax online generator**<http://support.automation.siemens.com/WW/CAXorder/default.aspx?lang=en&mlfb=3RU1926-3AA01>**Service&Support (Manuals, Certificates, Characteristics, FAQs,...)**<https://support.industry.siemens.com/cs/ww/en/ps/3RU1926-3AA01>**Image database (product images, 2D dimension drawings, 3D models, device circuit diagrams, EPLAN macros, ...)**http://www.automation.siemens.com/bilddb/cax_de.aspx?mlfb=3RU1926-3AA01&lang=en

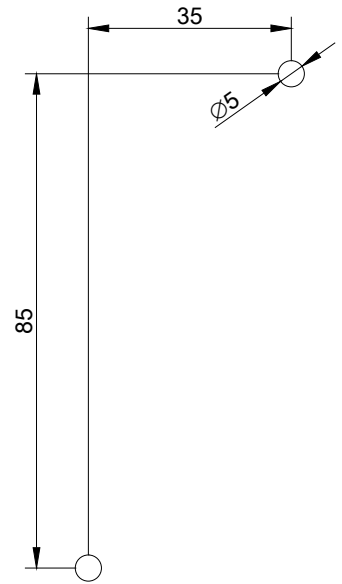
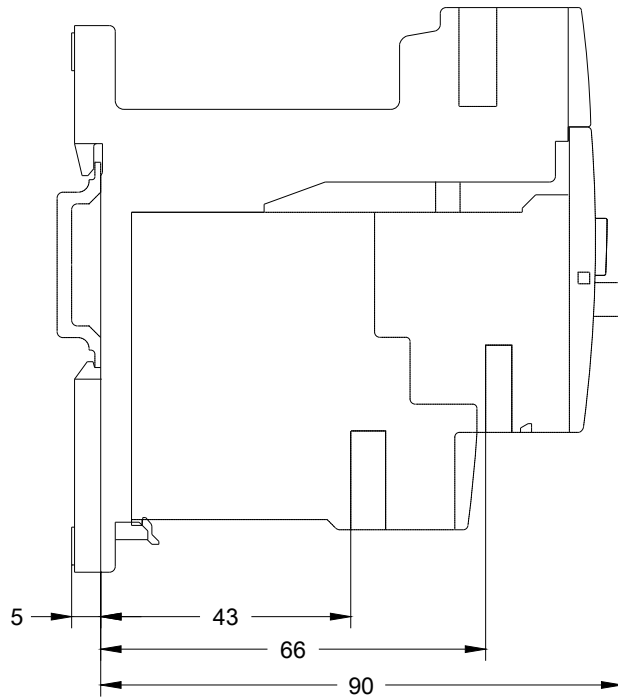
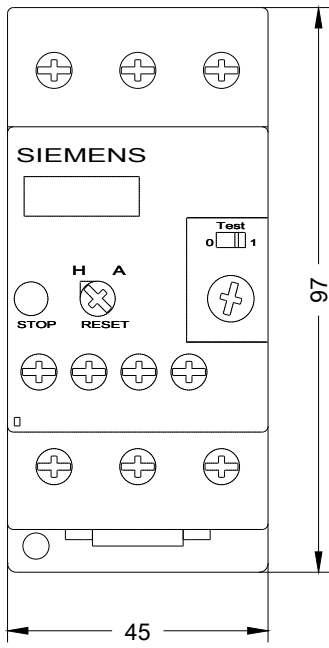

last modified:

06/20/2017