

FRONT VIEW
SHOWN WITHOUT RELAY INSTALLED

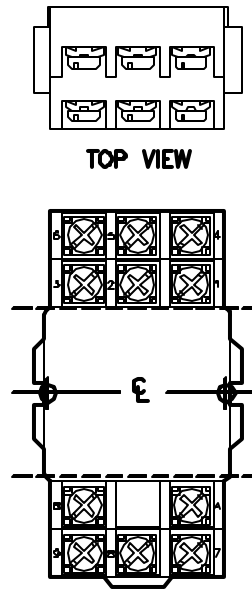

FRONT VIEW
SHOWN WITH RELAY INSTALLED

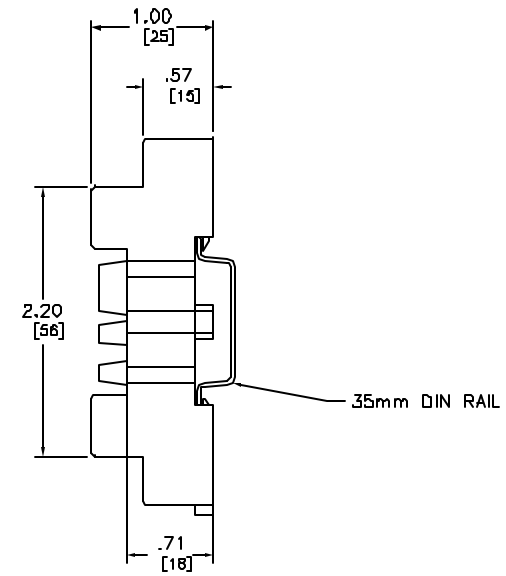

RIGHT VIEW

Catalog Number: 8501-NR82
 Ratings: 30DV, 15A
 UL File/CCN: E66924/5WV2
 CSA File/Class: LR35144/3211 Q7
 Meets Standards: -
 Weight: 0.1 lbs
 Wire Size: #12-#22 AWG
 Terminal torque: 7-8 LB/IN
 Mounting Hwd.: (2) #8-32 SCREWS, 35mm DIN RAIL

DUAL DIMENSIONS: INCHES
MILLIMETERS

GENERAL PURPOSE RELAY SOCKET (11 PIN)
CLASS B501 TYPE NR82



DWG# E0700201-01
NO.