

SEE CRIMP  
DETAIL

.62  
RAD

+.030  
-.000  
.270

1.24  
MIN.

22.5°  
2 PL.

.090 MIN.

20.00 ± 2.00  
@ 2.75 DIA.

CRIMP DETAIL  
2 PL.

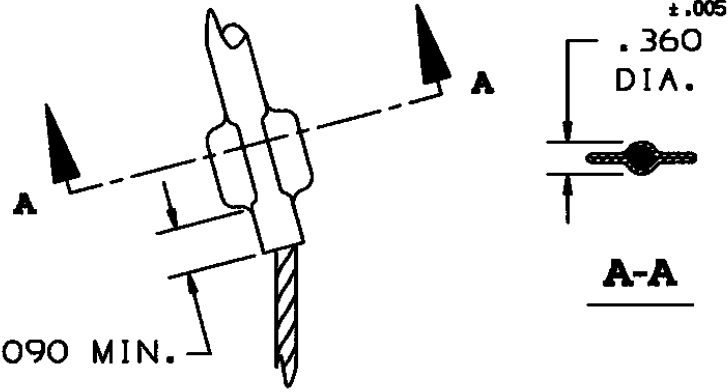

±.005  
.360  
DIA.

**A-A**

**COMPONENT LIST**

ITEM NO.	DESCRIPTION	MAT'L	COMPONENT NO.	QTY.
1	STRAND	T BRZ		-
2	EYE	CU		1
3	ROD	SST		1
4	TAG	MYLAR		1

IN ACCEPTING OUR DRAWINGS OR BLUEPRINTS FOR QUOTATION OR OTHER PURPOSES, YOU AGREE NOT TO DISCLOSE TO OTHERS THE IDEAS, INFORMATION, OR DESIGNS THEREIN SHOWN, AND THAT YOU WILL MAKE NO USE OF OUR DRAWINGS OR BLUEPRINTS OR OF THE IDEAS, INFORMATION, OR DESIGNS THEREIN SHOWN WITHOUT OUR PERMISSION.

TITLE GRIP, STD. SUPPORT, SPLIT ROD CLOSING SINGLE WEAVE, SINGLE OFFSET EYE DIA. RA. 2.50-2.99 APPROX. BRK. STR. 3100# ±20%

TOLERANCES UNLESS OTHERWISE SPECIFIED .X = ±.5 .XX = ±.05 .XXX = ±.015 ANGLE TOL. ± 2°	HUBBELL INCORPORATED KELLEMS DIVISION STONINGTON, CT	
	DR. BY KJW	APP. BY JLW

PROJECT NO.	TR. BY	SCALE N/A
/ /	CHK. BY JLW	DATE 11/8/93

DR. NO.	REV.
022-03-046	K